

Dimensions

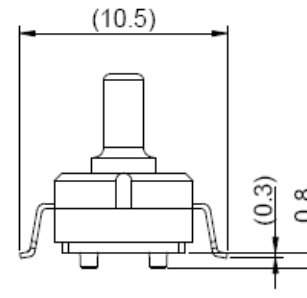

NOTES:

1. Port B is used for positive pressure.
2. All Dimensions are in mm.
3. Thru-hole pin configurations are available. Consult the factory for drawings.
4. A 0.1 uFd capacitor is required near the sensor between Vss and Ground.

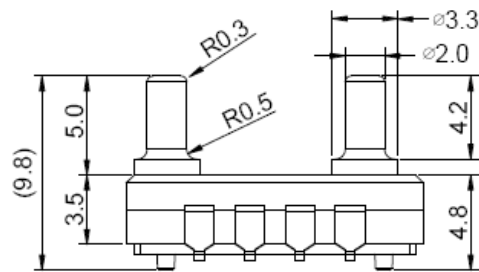
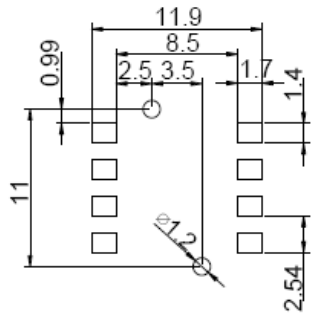
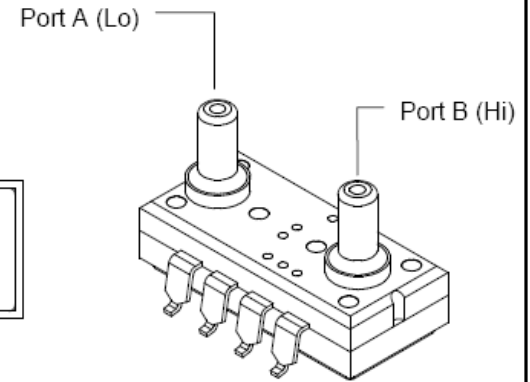
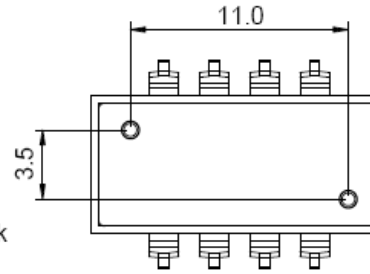
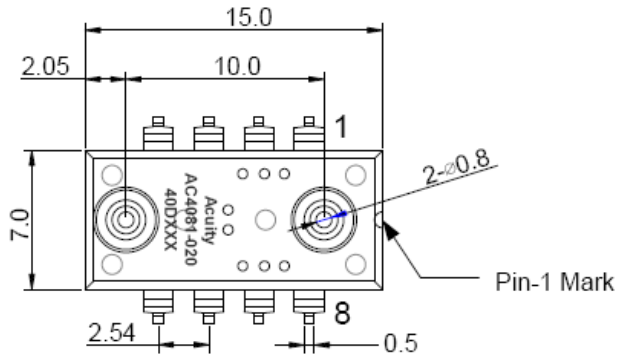
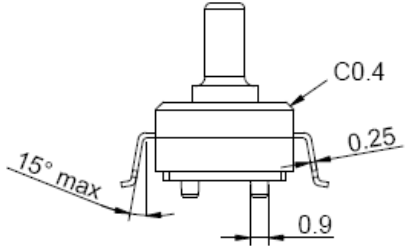
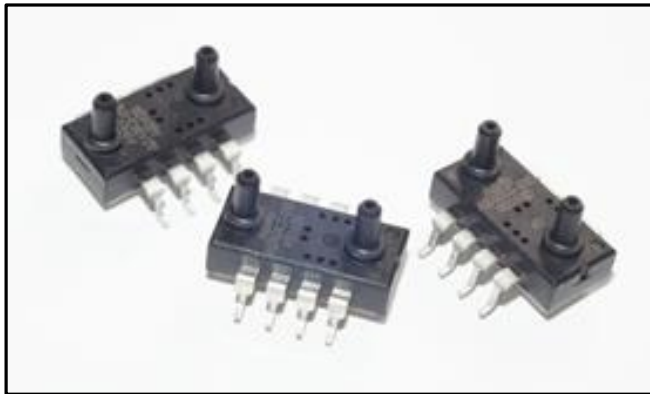

AC4080 – AC4081 Analog Pin-outs

Pin #	Description
1	NC
2	NC
3	NC
4	Vss (-Supply voltage)
5	Vss (-Supply voltage)
6	Analog Signal
7	Vdd (+ Supply voltage)
8	NC

NC = May not be used as an electrical feed-thru.
Pins should be soldered to the board but not connected to any other circuitry.

AC4082 – AC4083 Digital Pin-outs

Pin #	Description
1	Vss (-Supply voltage)
2	NC
3	Vdd (+ Supply voltage)
4	NC
5	NC
6	SDA
7	SDL
8	NC

NC = May not be used as an electrical feed-thru.
Pins should be soldered to the board but not connected to any other circuitry.

Acuity Incorporated
Fremont CA 94539 USA
www.acuitymicro.com



Acuity Incorporated

AC4080 Series
Dimensions and Pin-outs

Date: 3 Nov 2015

By: HVAllen

Revision: A